



**MODERN OFFICE CUBICLES | SAPPHIRE CUBICLE SYSTEM | SEATS 2 | 8X19X65"H**



**\$13,817.64**

- **Overall Footprint Size:** 19'7"W x 8'9"D x 65"H
- **Individual Workspace Size:** 6'W x 6'D x 65"H
- **Panels Pictured:**
  - **Fabric:** Charcoal and Slate
  - **Laminate:** White
  - **Glass:** Clear Tempered
- **Worksurface Pictured:** White
- **Trim Pictured:** Silver
- **Storage Shown:** 3-Drawer Box/Box/File Pedestals and Overhead Storage Cabinets



**Skutchi Designs, Inc.**

**(888) 993-3757**  
**[sales@skutchi.com](mailto:sales@skutchi.com)**

The configuration pictured is completely customizable! View the fabric and laminate options to the left

Contact our designers to create your dream office. 1-888-993-3757 or e-mail [sales@skutchi.com](mailto:sales@skutchi.com)

**SKU: SAPC-8x19x65**

## GALLERY IMAGES

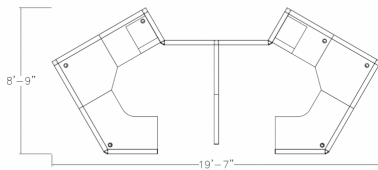

Drillwood

Sea Salt

Black Oak

White

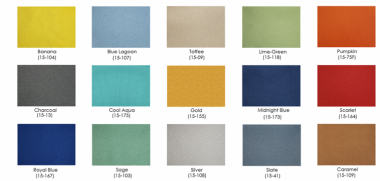

## PRODUCT DESCRIPTION

### Why Buy Our Modern Office Cubicles?

Are you looking for modern office cubicles? The [Sapphire Cubicle System](#) is our premier cubicle workstation product line. This commercial-grade cubicle system is both scalable and durable. Its lightweight construction makes it a sound investment for any office or work environment. Because of its modular design, any number of modern office cubicles can be made; pictured here is a 2-person typical.

Also, this cubicle system features a variety of choices for the panels (multi-colored fabrics, patterned laminates, and tempered glass) and offers panels reaching 39", 52", and 65" in height. And don't forget,



this cubicle system also offers electrical cord/data networking cable conduits along the base of each panel to hide cable clutter.

### **What Comes With This Product?**

The modern office cubicles pictured on this page shows our **Sapphire Cubicle System** divider panels with wrap-around desk surfaces. You can select alternate colors for the panels, the overall dimensions of the workspace sizes, the height of the panel divider walls, and the shape of the worksurfaces if you'd like. Also, there are many extras you can add to your cubicle workspaces such as locking storage bins, pedestal cabinets, accessory racks, monitor arms, paper trays, writing utensil holders, and many other features to complete your project.

### **What Else?**

Finally, it's important you have a clear understanding of all accessories and choices available for our modern office cubicles. For this reason, we suggest you contact *SKUTCHI Designs Inc.* today. We'd be happy to answer your questions before your purchase.