

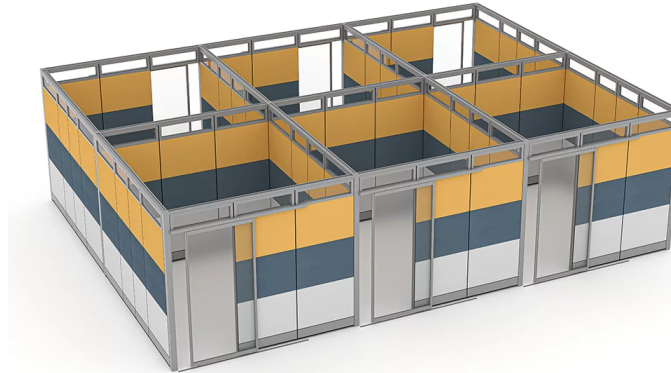

## FREESTANDING CUBICLES WITH SLIDING DOOR | 6 OFFICE SPACES | 9' X 10' X 95" H



**\$71,404.67**

- **Actual Footprint Size:** 27'8"W x 20'6"D x 95"H
- **Individual Workspace Size:** 9'W x 10'D x 95"H
- **Panels Pictured:**
  - **Fabric:** Slate and Gold
  - **Laminate:** White
  - **Glass:** Stacker Panel No Frost
- **Worksurface Pictured:** None
- **Door Shown:** Sliding Door
- **Trim Pictured:** Silver



Skutchi Designs, Inc.

(888) 993-3757  
sales@skutchi.com

The configuration pictured is completely customizable! View the fabric and laminate options to the left

Contact our designers to create your dream office. 1-888-993-3757 or e-mail [sales@skutchi.com](mailto:sales@skutchi.com)

SKU: SAPW-E0-9X10X95H-08-F-SLD.F

## GALLERY IMAGES

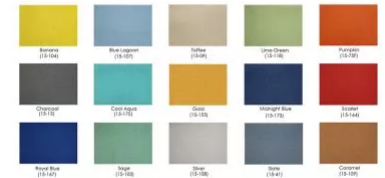
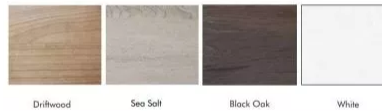
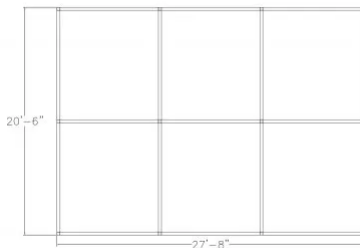

## PRODUCT DESCRIPTION

### Why Buy Our Freestanding Cubicles?

The **Sapphire Wall System** offers a freestanding cubicle arrangement which can be built to a variety of shapes and sizes. This highly versatile panel system--with heights ranging over 7', 8' or 9'ft--is completely freestanding with no permanent attachments to your floor or ceiling.



In other words, our freestanding cubicles are fully demountable. It usually takes less than a day to assemble (depending on the size of the project).

You can also customize the panels of our freestanding cubicles in a variety of ways; choose all glass or mix in laminates and fabric panels. We offer multiple color fabric and laminate options. The **Sapphire Wall System** is a beautiful, modular wall alternative to traditional drywall construction--which can take weeks of construction and downtime.

### **What Comes With This Product?**

This six-station cubicle arrangement stands 27'8"W x 20'6"D x 95"H overall. This creates six, individual work areas which are 9'W x 10'D. As you can see from the rendering on this page, each freestanding cubicle includes a sliding door made from an acrylic panel for extra privacy.

Additionally, we offer built-in "raceways" along the bottom of our walls to provide hidden electrical and data network management. Just as important, you can change or replace panels instead of the entire wall. In short, our freestanding cubicles are customized to suit almost any business or office. If your business needs to relocate, then take them with you to your new location and reconfigure as needed.

### **What Else?**

All typicals made with our **Sapphire Wall System** are fully compatible with any items available in our [\*\*Sapphire Cubicle System\*\*](#), which includes workstations, furniture, and accessories such as file storage, shelving, overhead storage, desks, chairs, and padded benches, paper racks, and accessory rails. Give us a call to customize yours today!